

# PARK DISTRICT EAST LANSING

WES JONES // MAUDIE SMITH // ELLE DANIELS

# INVENTORY & ANALYSIS

## HISTORY



- + East Lansing began to be settled the same year Lansing became the State capital in 1847.
- + Michigan State University was founded in 1855 in East Lansing as a Land Grant College prior to the Morrill Act.
  - Acted as national model for all following Land Grant Schools.
- + Everyone lived on-campus for 4 Decades.
  - That began to change in 1887 with William J. Beal building 'CollegeVille', between the roads of Harrison and Beal.

## PEOPLE WANT TO SEE, AND BE SEEN

Successful downtown areas give priority to the people by giving them opportunity to:



## PRESENT

### 'CREATING COMMUNITY THROUGH, PEOPLE, PARKS, & PROGRAMS'

Mission Statement of the East Lansing Department of Parks, Recreation, & Arts

East Lansing, the bustling and active nightlife center for the student body of the adjacent Michigan State University is hoping to undergo a transformation in the coming decade to bring and more mature atmosphere to the city. Focused on bringing arts and culture to the forefront of the cities interests in order to expand the demographic of those who are attracted to the city. All of this is to happen while retaining and expanding the engaging activities that bring the young demographic of MSU's student body to the downtown area. While many developments have, and are taking place in small installations, the major initiative is the re-design and consequent re-development of the Park Planning District/City Center II.

'East Lansing, a City of the Arts'

## THE SITE

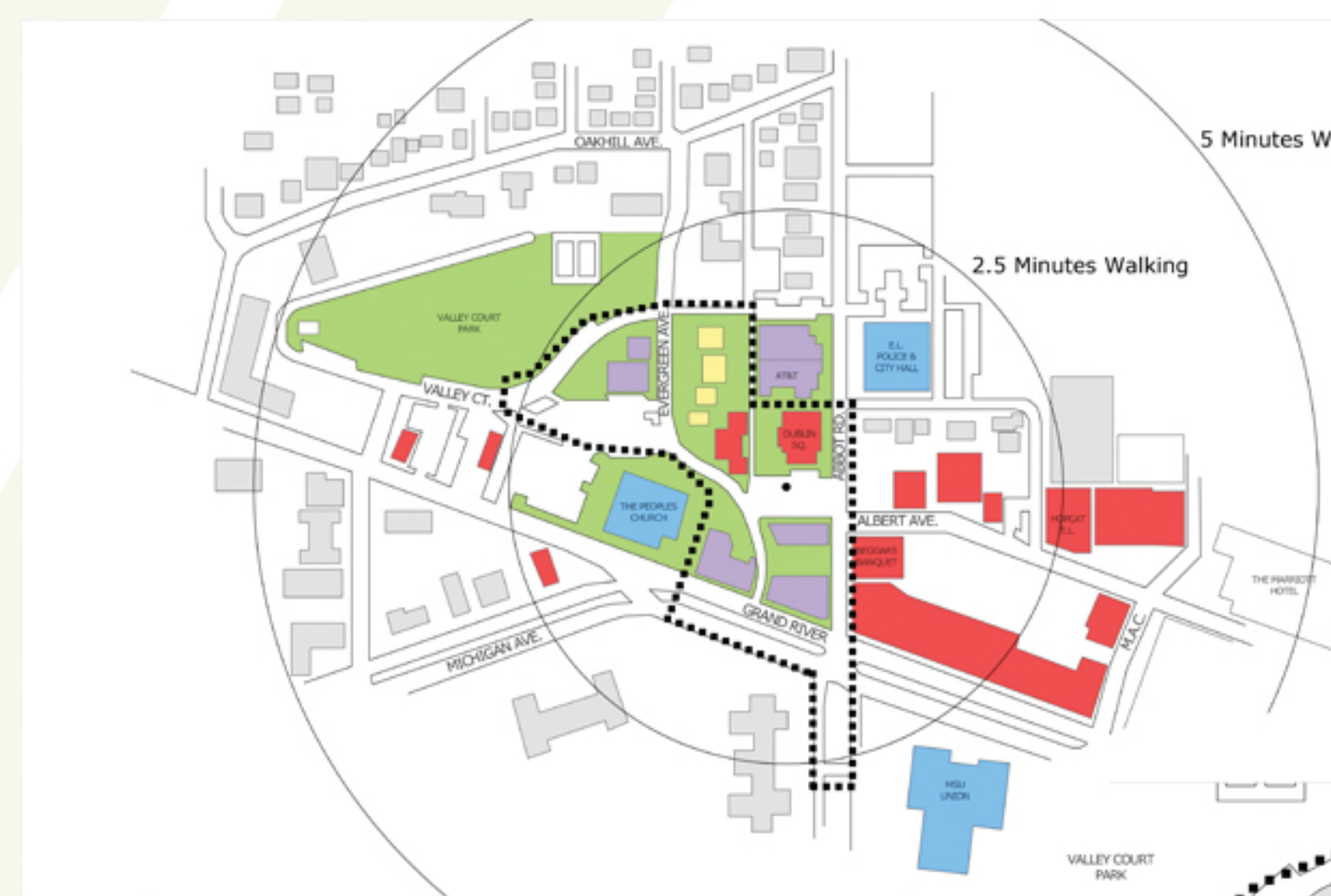

The site of the Park Planning District / City Center II of East Lansing is located to the North West of the corner of Abbot Rd. and Grand River Rd. The site is within 5 minutes walking distance of the current center of the downtown area, however Abbot Rd. acts as a Western edge to the city. Currently the only building with activity within the site boundary is Dublin Square. The rest of the buildings are uninhabited and have gone into disrepair. This allows for immense opportunity to expand the downtown area of East Lansing past Abbot Rd. and provide added functions and amenities for the residents.

The site currently acts as a thoroughway for residents living to the North West to travel through to their homes or the downtown area. The site currently has very little things of interest that would draw people to the area. The only place of activity is Dublin Square, however from there people move East into the downtown area. The local CATA Bus System currently bypasses the area.

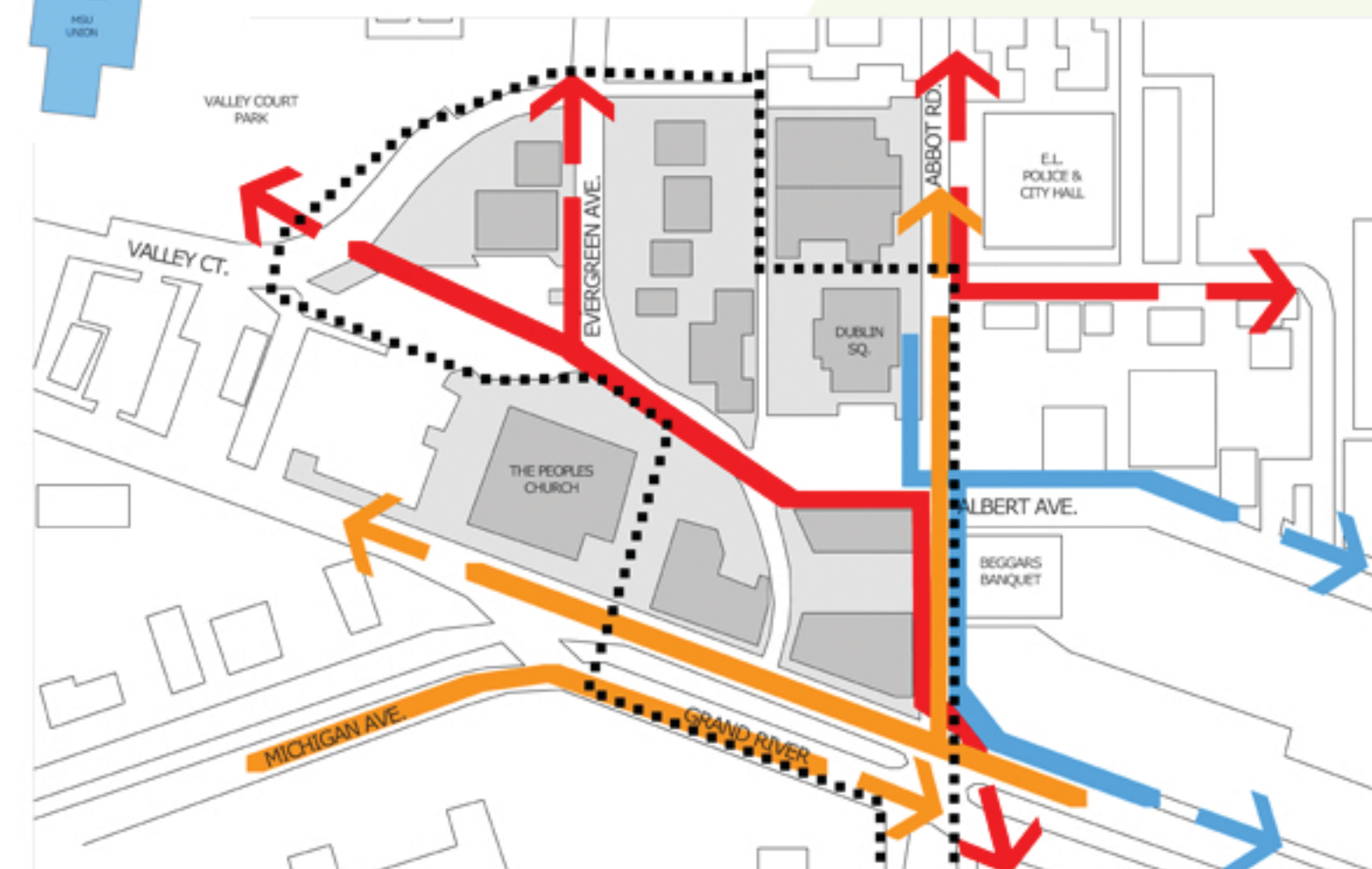

**GREEN SPACE**

- ACTIVE OPEN
- NATURAL OPEN

The site is enclosed with Active Open Space, however the site itself remains natural and thus deters people from recreating or enjoying the site. An opportunity for the site would be to add pockets of Active Open Space to encourage activity throughout the site.

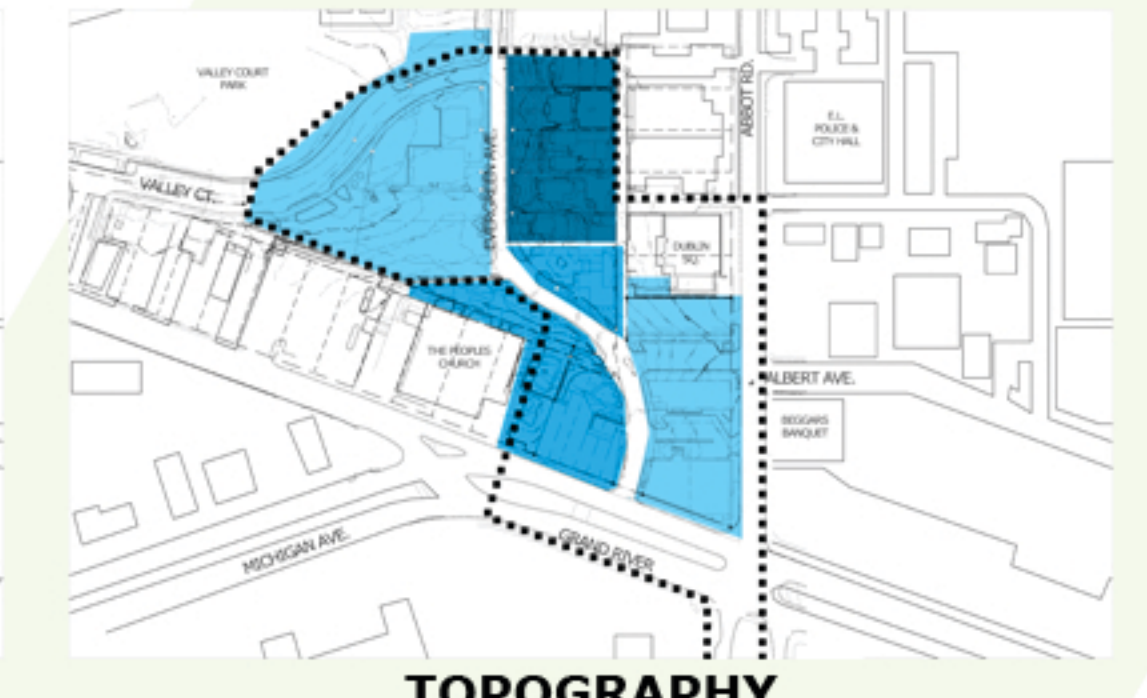

**TOPOGRAPHY**

- 0-5%
- 5-8%
- 8-12%

The topography of the site drops as one moves North West through the site. This change in topography allows unique opportunities for architecture and creating open space as much of East Lansing remains relatively flat, this change in grade could act as a major attraction to the site.



Sun patterns are an important factor in determining views and location of buildings. A naturally open site, allows for opportunity with building placement and site amenities to create and control the areas of shade and sun exposure across the site. The changes in sun position can allow for a dynamic space that always seems to be changing with its environment.

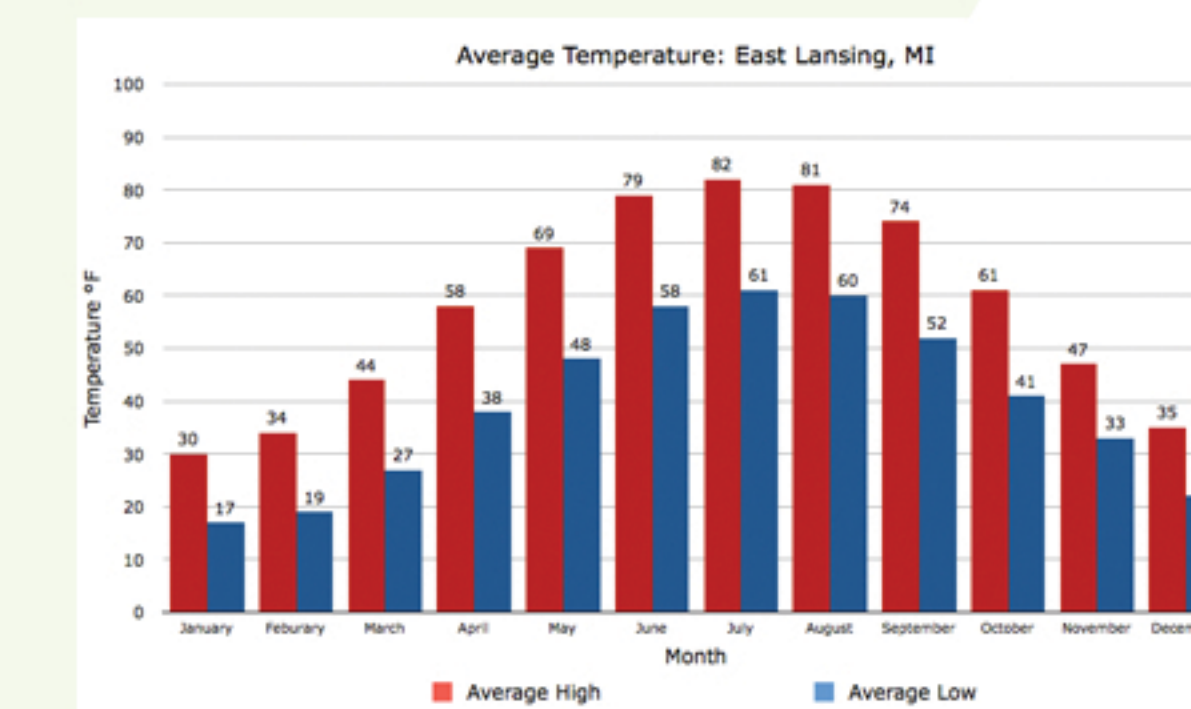
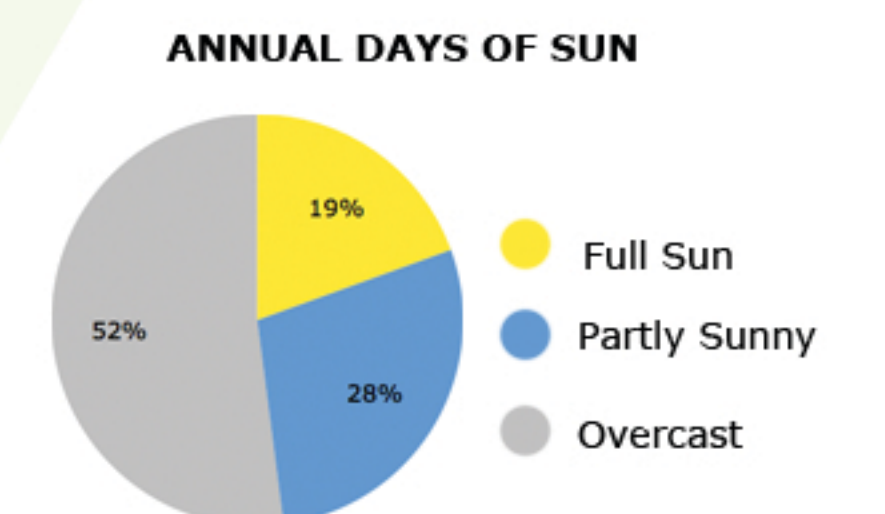
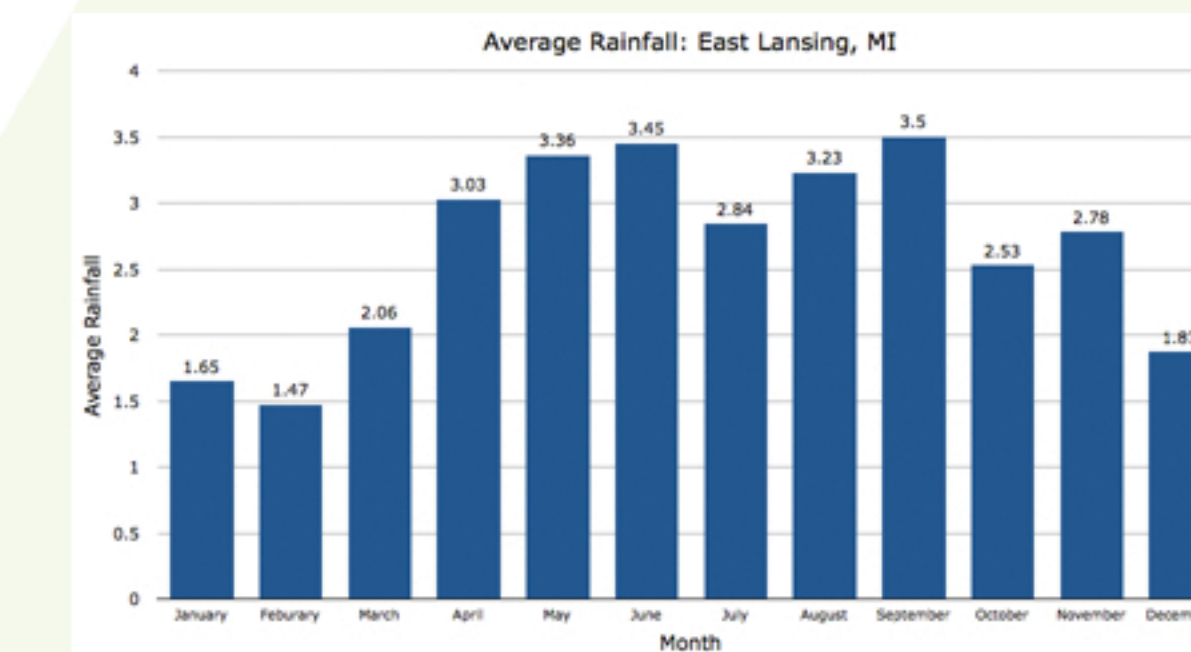

Being a Mid-Western town the weather is known to change from extremes on any given day. These environmental factors are crucial to the consideration of what the space is to become so that no matter the conditions the area will function as it is intended and become the activity center of the downtown area.

Seeing the extremes from the charts and graphs, a key design philosophy to be implemented will be transitional spaces. Those that connect the indoors to the out in order to keep people engaged in the space. This allows them the opportunity to continue utilizing the space in its same function as one can transition to a location where conditions are more favorable with ease.

